

REVISION HISTORY			
REV	ECO NUMBER	DATE	APPROVED
0	ECO-02582	6/18/2009	FED

Bill of Material						
ITEM	PART NUMBER	STOCK NUMBER	QTY	DESCRIPTION	FILE NAME	REV
1			1	84"H x 42"D COVER PANEL FOR SIDE CAR	I008450.ipt	0
2	H09-003		4	EMHART - GRIPCO TAB WELD NUT #SIC-56-S, 5/16-18 THDS.	H09-003.ipt	-
3	7538-5-1		2	LEVELING GLIDE, 5/16-18 X 2 1/2" THREADS, 1/2" HIGH X 1 3/8" DIA. BASE, SUPERIOR COMPONENTS (CARPIN MFG#R: 045NP31250000LN)	7538-5-1.ipt	-
4	22N131110	H02-052	2	5/16-18 HEX NUT w/SERRATED FLANGED LOCK NUT - ILS	22N131110.ipt	-
5	H01-078	H01-078	13	SCREW, 10-32x1/2" PH PAN TYPE 23 BLACK OXIDE/WAX RoHS	SCR1032X500BLK.ipt	-
6	10-32STOPNUT		13	10-32 ELASTIC STOP NUT, 22N3687	10-32STOPNUT.ipt	-

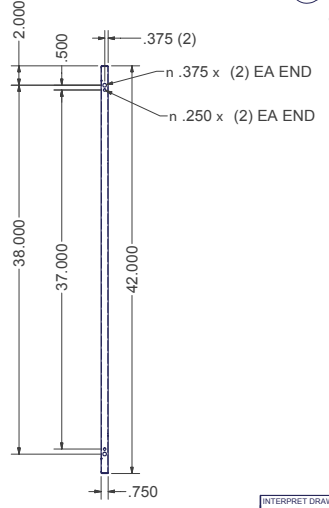
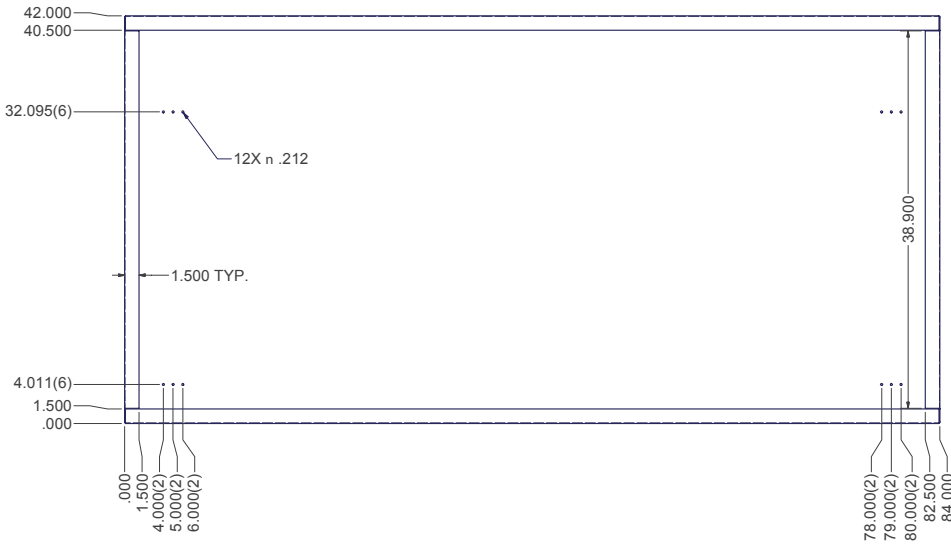
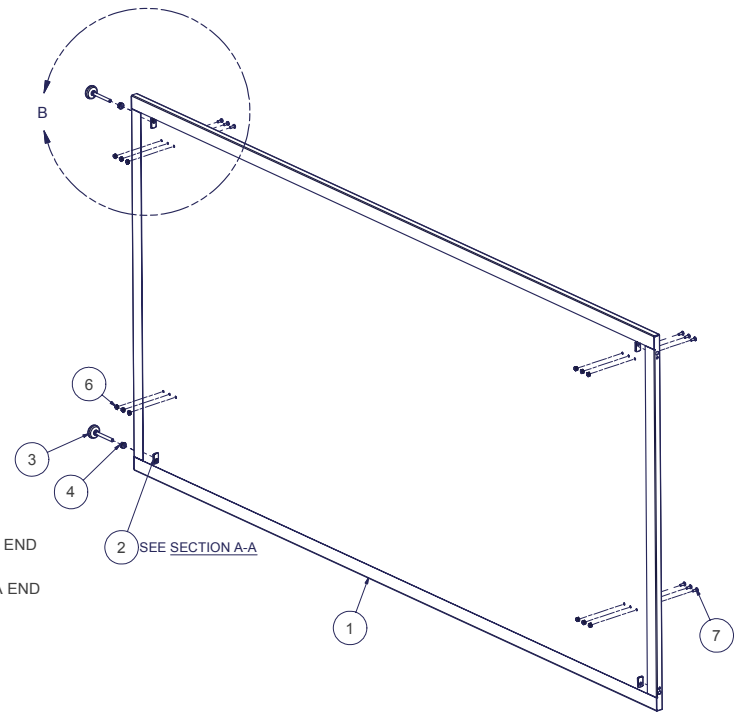
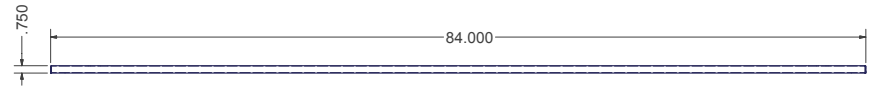
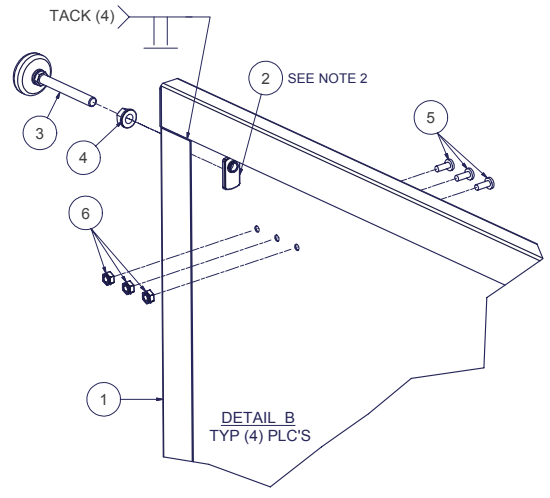
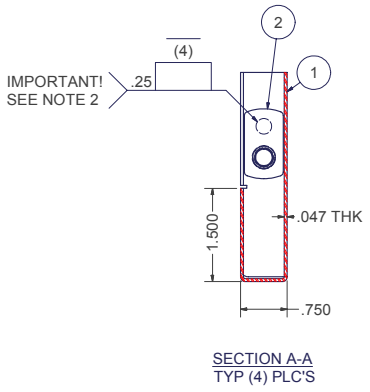

INTERPRET DRAWING PER ASME Y14.5M-1994 DIMENSIONAL LIMITS APPLY AFTER APPLICATION OF FINISH DRAWING NOT TO SCALE TOLERANCE UNLESS OTHERWISE NOTED: ANGULAR +/- 1° XXXX +/- .010 XXX +/- .015 XX +/- .030 X FOR REF. ONLY		NOTICE: Use of this document is subject to a confidentiality and nondisclosure agreement with Great Lakes Case & Cabinet Co., Inc. (GLCC) and may not be reproduced, disclosed or utilized in whole or in part without prior written authorization from GLCC.		PART NUMBER: SCP8442 QTY PER UNIT: 1 MATERIAL TYPE: CRS MATERIAL GAUGE: FINISH: SEE NOTES DRAWN: FED CHECKED & APP: WSS		TITLE: 84"H x 42"D COVER PANEL FOR SIDE CAR GREAT LAKES CASE & CABINET CO., INC. P.O. BOX 551 EDINBORO, PA 16412 PHONE: (814) 734-7323 FAX: (814) 734-3907 E-MAIL: glcc@greatlakescabinets.com		DWG NO: I008450 REV: 0 SHEET: 1 OF 1	
UNLESS OTHERWISE SPECIFIED ALL DIMENSIONS ARE IN INCHES THIRD ANGLE PROJECTION		DATE: 6/18/2009 DATE: 6/18/2009							