

REVISION HISTORY			
REV	DESCRIPTION	DATE	APPROVED
0	ECC-02814	3/15/2010	FED
1	ECC-02884	6/10/10	CD

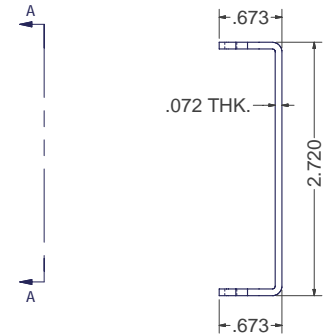

- SPECIAL NOTES:**
1. FINISH PER TD-09-103 (POWDER COAT), CLASS B, TEXTURE LEVEL 3 - ALL SURFACES UNLESS OTHERWISE NOTED.
 2. DIMENSIONS APPLY BEFORE APPLICATION OF FINISH: ADD .005\"/>
 - 3. TYPICAL BEND = R0.030\"/>
 - 4. TO BE BULK-SHIPED ON PALLET.

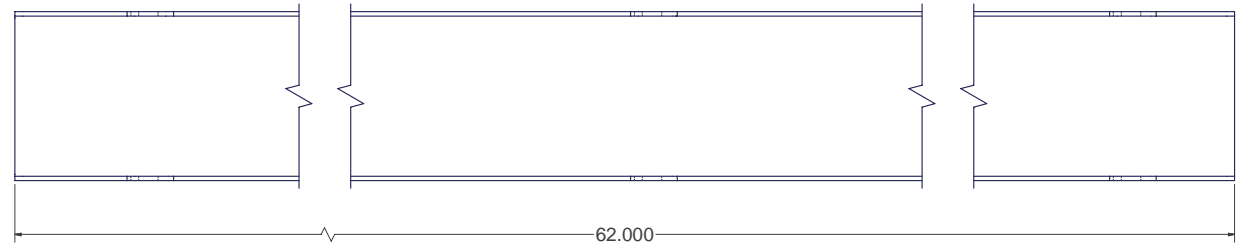
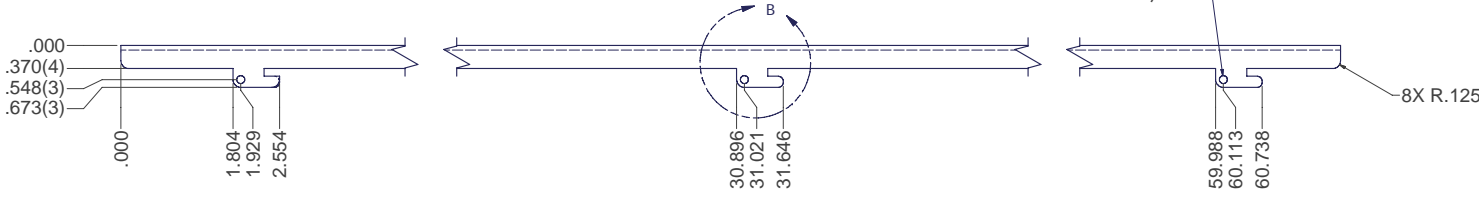
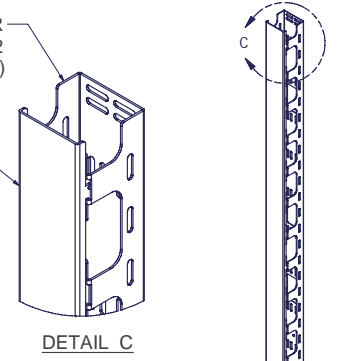
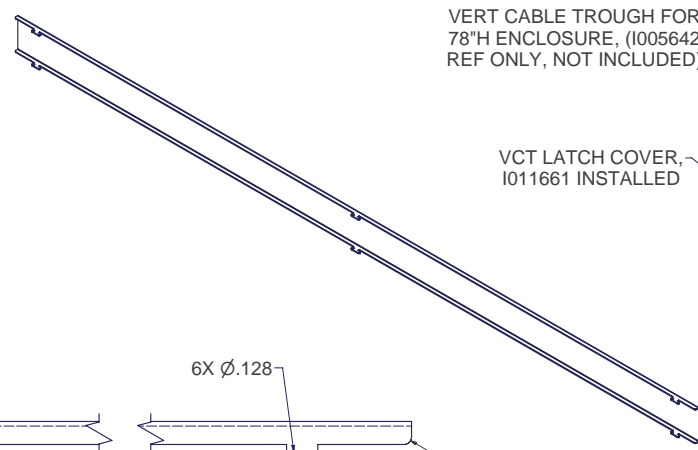
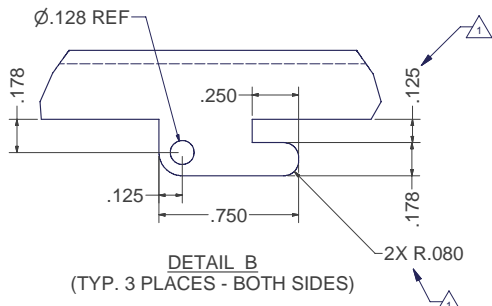

INTERPRET DRAWING PER ASME Y14.5M-1994
DIMENSIONAL LIMITS APPLY AFTER APPLICATION OF FINISH
DRAWING NOT TO SCALE
TOLERANCE UNLESS OTHERWISE NOTED: ANGULAR +/- 1' XXX +/- .010 XXX +/- .015 XX +/- .030 X FOR REF. ONLY
UNLESS OTHERWISE SPECIFIED ALL DIMENSIONS ARE IN INCHES

NOTICE:
Use of this document is subject to a confidentiality and nondisclosure agreement with Great Lakes Case & Cabinet Co., Inc. (GLCC) and may not be reproduced, disclosed or utilized in whole or in part without prior written authorization from GLCC.

PART NUMBER: VCT-78CX100	TITLE: VCT LATCH COVER - FOR VCT78, 62\"/>
QTY PER UNIT: 1	MATERIAL TYPE: CRS
MATERIAL GAUGE:	FINISH: SEE NOTES
DRAWN: JL	DATE: 3/15/2010
CHECKED & APP: WSS	DATE: 3-15-2010
DWG NO: I011661	REV: 1
SHEET: 1 OF 1	

GREAT LAKES CASE & CABINET CO., INC.
P.O. BOX 551 EDINBORO, PA 16412
PHONE (814) 734-7303 FAX (814) 734-3907
E-MAIL glcc@greatlakescabinets.com