

REVISION HISTORY			
REV	DESCRIPTION	DATE	APPROVED
0	ECO-01961	6/21/2007	JL

Bill of Material					
ITEM	PART NUMBER	QTY	DESCRIPTION	FILE NAME	REV
1	VCT-84X100	1	VERTICAL CABLE TROUGH - FOR 84"H ES & LE ENCLOSURE, 2.5"W x 3"D	I005641.ipt	0
2	H01-068	2	SCREW, 10-32x3/8" Ph PAN TYPE 23 BLACK OXIDE/WAX RoHS	SCR10-32X375SC23.ipt	-
3	H01-078	2	SCREW, 10-32x1/2" PH PAN TYPE 23 BLACK OXIDE/WAX RoHS	SCR1032X500BLK.ipt	-
4	H02-001	2	#10-32 KEPS NUT, ZINC RoHS	10-32NUT.iam	-

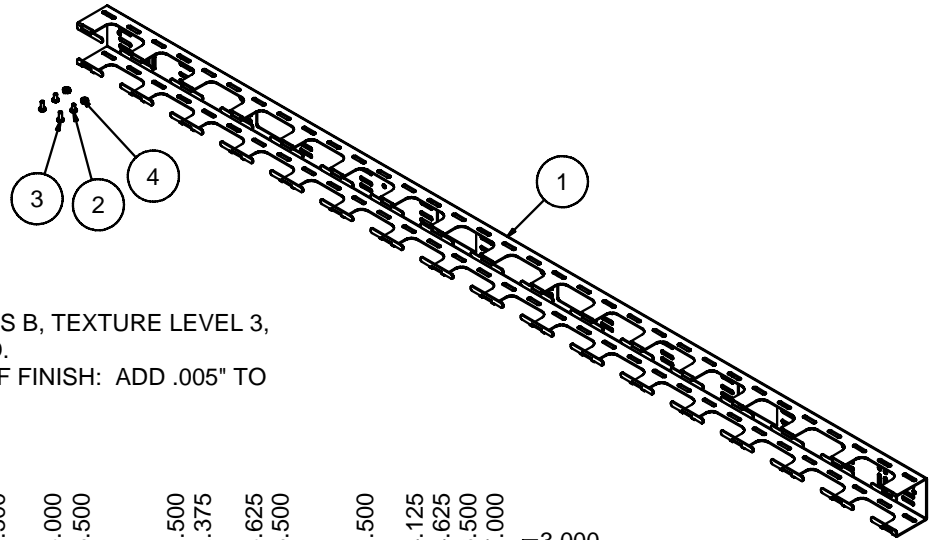
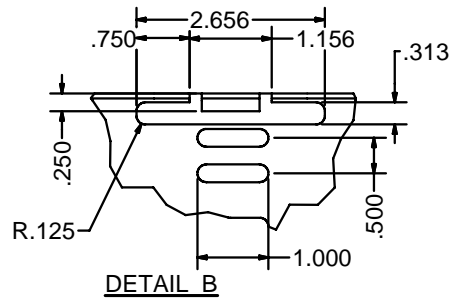
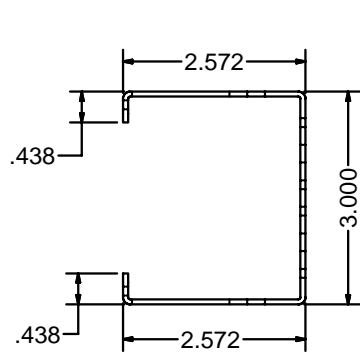

VIEW A-A

SPECIAL NOTES:

- 1) FINISH PER TD-09-103 (POWDER COAT), CLASS B, TEXTURE LEVEL 3, - ALL SURFACES UNLESS OTHERWISE NOTED.
- 2) DIMENSIONS APPLY BEFORE APPLICATION OF FINISH: ADD .005" TO EACH SURFACE FOR INSPECTION.
- 3) TYPICAL BEND RADIUS = 0.030

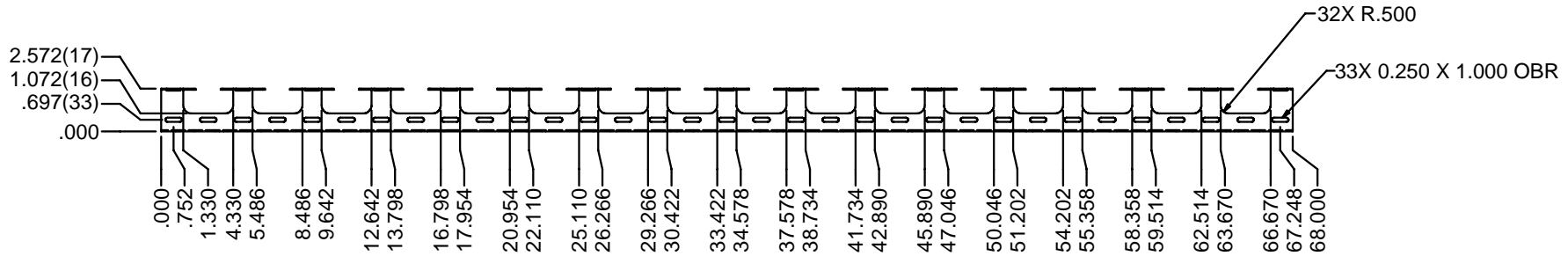
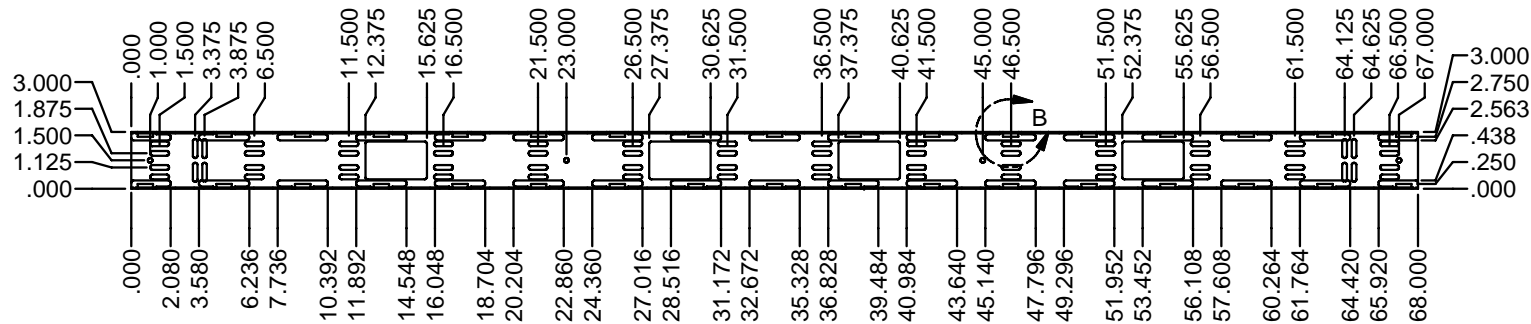

INTERPRET DRAWING PER ASME Y14.5M-1994	
DIMENSIONAL LIMITS APPLY AFTER APPLICATION OF FINISH	
DRAWING NOT TO SCALE	
TOLERANCE UNLESS OTHERWISE NOTED:	
ANGULAR +/- 1'	
.XXXX +/- .010	
.XXX +/- .015	
.XX +/- .030	
.X FOR REF. ONLY	

NOTICE:
Use of this document is subject to a confidentiality and nondisclosure agreement with Great Lakes Case & Cabinet Co., Inc. (GLCC) and may not be reproduced, disclosed or utilized in whole or in part without prior written authorization from GLCC.

PART NUMBER:	VCT-84X100
QTY PER UNIT:	1
MATERIAL TYPE:	CRS
MATERIAL GAUGE:	14 GA
FINISH:	SEE NOTES
DRAWN:	JAL
DATE:	6/21/2007
CHECKED & APP.:	WSS
DATE:	6-21-07

TITLE		VERTICAL CABLE TROUGH - FOR 84"H ES & LE ENCLOSURE, 2.5"W x 3"D	
GREAT LAKES CASE & CABINET CO., INC.			
P.O. BOX 551 EDINBORO, PA 16412			
PHONE (814) 734-7303 FAX (814) 734-3907			
E-MAIL glcc@greatcabinets.com			
DWG NO:	I005641	REV:	0
SHEET: 1 OF 1			



UNLESS OTHERWISE SPECIFIED ALL DIMENSIONS ARE IN INCHES