

REVISION HISTORY			
REV	DESCRIPTION	DATE	APPROVED
0	ECO-06771	2/9/2016	VL
1	ECO-07355	3/28/2018	VL

1 REMOVED HARDWARE & INSTALLATION INSTRUCTIONS

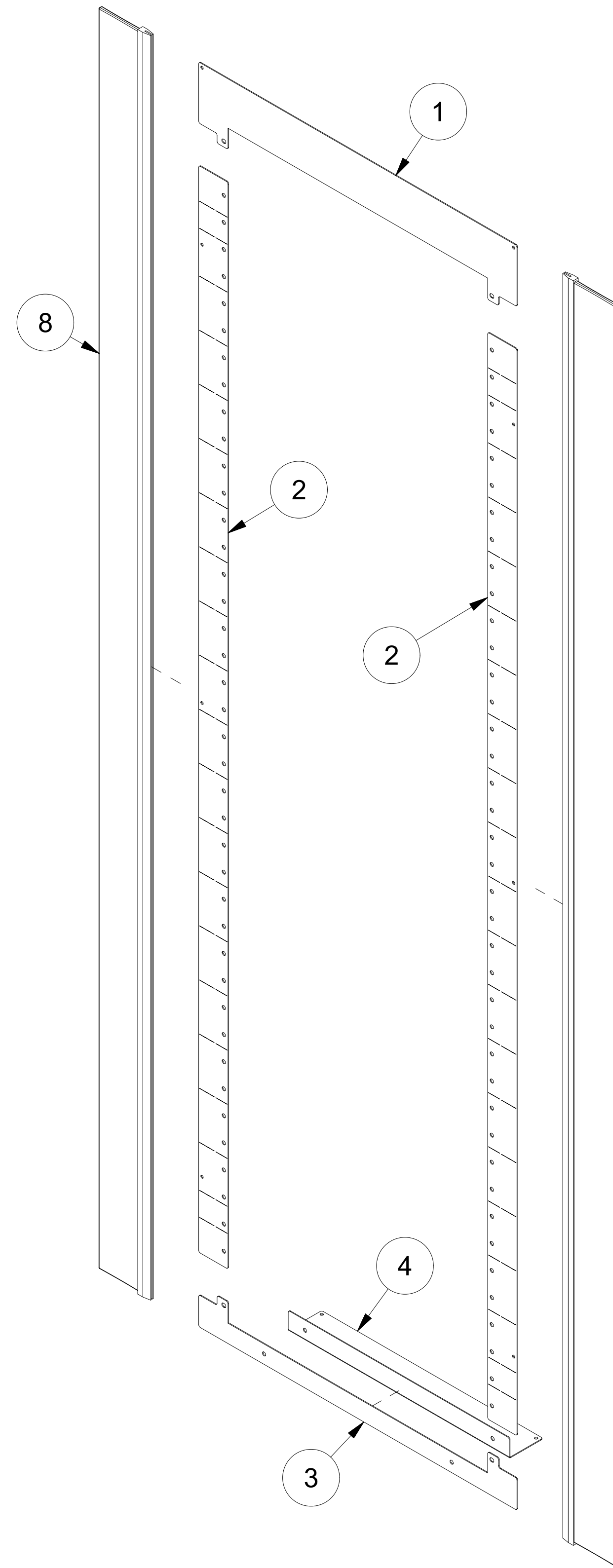
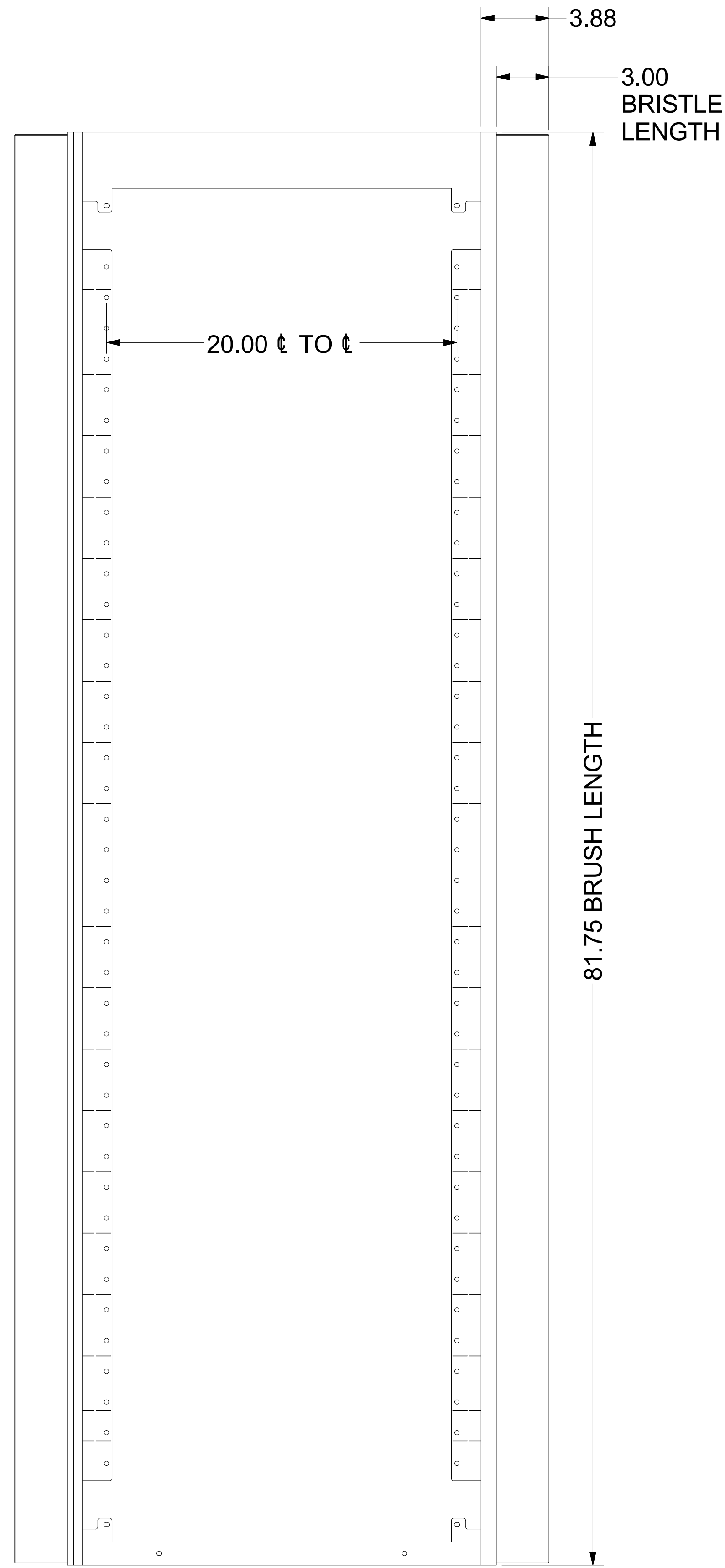

Bill of Material						
ITEM	PART NUMBER	STOCK #	QTY	DESCRIPTION	FILE NAME	Rev
1	I025286		1	BRUSH GROMMET RAIL KIT, TOP CROSS PLATE, 84 H & 91H x 29" & 30"W "ES" FRAMES	I025286.ipt	0
2	I025283		2	BRUSH GROMMET RAIL KIT, VERTICAL MTG PLATE, 84 H x 29" & 30" W "ES" FRAMES	I025283.ipt	0
3	I025287		1	BRUSH GROMMET RAIL KIT, BOTTOM CROSS PLATE, 84 H & 91H x 29" & 30"W "ES" FRAMES	I025287.ipt	0
4	I025292		1	BRUSH GROMMET RAIL KIT, BRACKET FOR BOTTOM CROSS PLATE, 84 H & 91H "ES" FRAMES	I025292.ipt	0
8	14006785-81.75	H48-003-81.75	2	BRUSH STRIP, FLEXIBLE PVC, 3" Trim, CUT 81.75" LG. (TANIS INC.)	H48-003-81.75.ipt	-
9	100-0333	100-0333	1	BGRK BULK PACK KIT CTNS (S&S PACKAGING)	100-0333.ipt	-

SPECIAL NOTES:

- 1) REFER TO PURCHASE ORDER - SPECIAL REQUIREMENTS MAY APPLY!
- 2) CUT BRUSH STRIPS TO LENGTHS SHOWN AND QUANTITIES SHOWN.
- 3) NOTE REMOVED.
- 4) DO NOT WRAP ANY SHEET METAL PARTS OR BRUSH PIECES AS IT COULD DAMAGE BRISTLES OR BEND VERTICAL MOUNTING PLATES.
- 5) PACKAGE EACH KIT USING #100-0333 CARTON. SEE SHEET 2 FOR PACKAGING INSTRUCTIONS.
- 6) WRAPPING COMPLETE SKID IS ACCEPTABLE.

EST. WEIGHT :
N/A

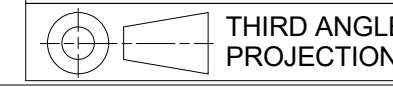

INTERPRET DRAWING PER ASME Y14.5M-1994
DIMENSIONAL LIMITS APPLY AFTER APPLICATION OF FINISH
DRAWING NOT TO SCALE
TOLERANCE UNLESS OTHERWISE NOTED:
ANGULAR +/- 1'
.XXXX +/- .010
.XXX +/- .015
.XX +/- .030
.X FOR REF. ONLY
UNLESS OTHERWISE SPECIFIED ALL DIMENSIONS ARE IN INCHES

NOTICE:
Use of this document is subject to a confidentiality and nondisclosure agreement with Great Lakes Case & Cabinet Co., Inc. (GLCC) and may not be reproduced, disclosed or utilized in whole or in part without prior written authorization from GLCC.

PART NUMBER:
BGRK8430X100
MATERIAL TYPE:
CRS
MATERIAL GAUGE:
FINISH:
POWDERCOAT
DRAWN VL DATE 2/1/2016
CHECKED & APP. WSS DATE 2/12/2016

TITLE
BRUSH GROMMET RAIL KIT, FOR 84" HIGH X 29" & 30" WIDE "ES" SERVER, VENDOR LEVEL
GREAT LAKES CASE & CABINET CO., INC.
P.O. BOX 551 EDINBORO, PA 16412
PHONE (814) 734-7303 FAX (814) 734-3907
E-MAIL glcc@greatcabinets.com
DWG NO:
1025282
REV
1
SHEET: 1 OF 2