

# GL7202D PDU

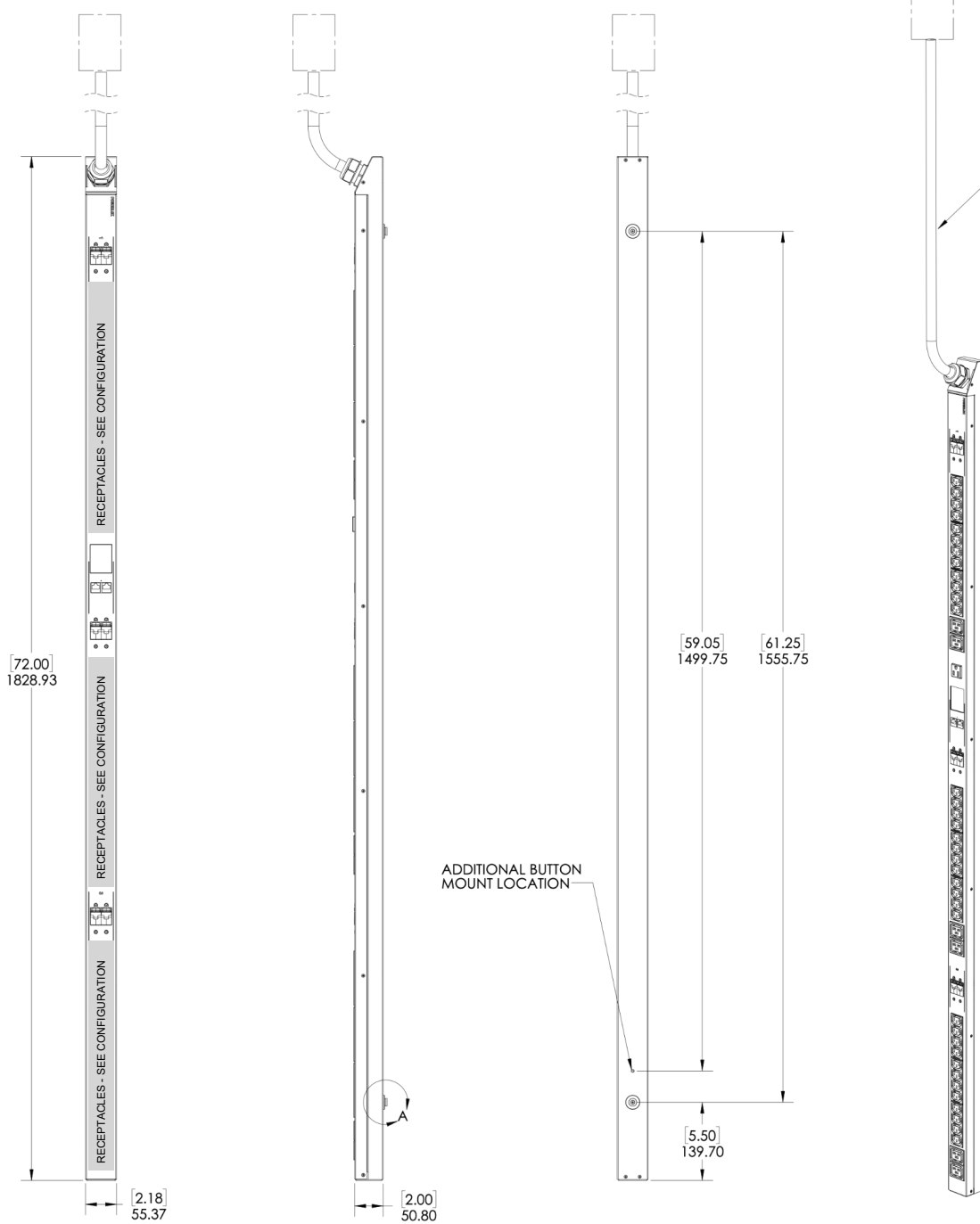

## MONITORED RACK PDU SPECIFICATION

Monitoring Accuracy	Voltage: +/- 0.5% at nominal. Current: +/-1% of measurement from 500mA to 30A. Within 0.5% from 1A to 30A typical
Total Unit & Group Monitoring	Aggregate (kWh, W, VA) plus Phase: A, B, C Line Currents, plus Group: 1, 2, 3 Monitoring (kWh, W, VA, PF, V, A)
Network Interface	Ethernet RJ-45
Transport/Internet	TCP/IP v4
Network Applications	HTTP Webserver; SNMP-V1/V2c Network Management; DHCP for dynamic IP address request from a server on the network; Remote firmware upgrade using FTP
Digital Display	Touch to rotate / touch to view data screens
Internal RMS Sensor	Current Sensor: Yes; Voltage Sensor: Yes
Over Current Protection	20A magnetic breakers on 30A models
Power Whip	20A: 12AWG 3 or 5 wire & 30A: 10AWG 3 or 5 wire
Operating Temperature	Full nameplate continuous operation: 0-50°C (32-122°F)
Rack PDU Type	Vertical rack-mount
Toolless Mounting	Center spacing, 61.2" (12.25 spacing standard); 59.05" mounting option available on rack PDU
USA Assembly	Yes, with local and off-shore sourced components
Product Warranty	3 year from date of shipment, repair or replace
Certification/ Agency Approvals	TUV Certified to UL/CSA 60950-1 with NOM Addendum for Mexico, FCC Part 15 Class A Conformance, RoHS Compliant
Operating Environment	0-50°C (32-122°F), 5-95% Relative Humidity, 0-10,000 ft. (0-3000 meters) Elevation
Storage Environment	-25-65°C (32-122°F), 5-95% Relative Humidity, 0-10,000 ft. (0-3000 meters) Elevation
Chassis Dimensions	72"L x 2.18"W x 2.0"D
Package Dimensions	84"L x 22"W x 5"D (4-Pack); 84"L x 11"W x 5"D (2-Pack); 84"L x 7"W x 5"D (1-Pack)
Rack PDU Weight	15 lbs. (Actual weight varies slightly based on configuration)
Packaged Weight	17 lbs. (1 unit - actual weight varies slightly based on configuration)



PLUG TYPE PER MODEL'S SPECIFICATION

CORD LENGTH - PER MODEL'S SPECIFICATION  
VARIABLE: 3-10 FT  
(1 FT INCREMENTS)

**MOUNTING BUTTON DETAILS**

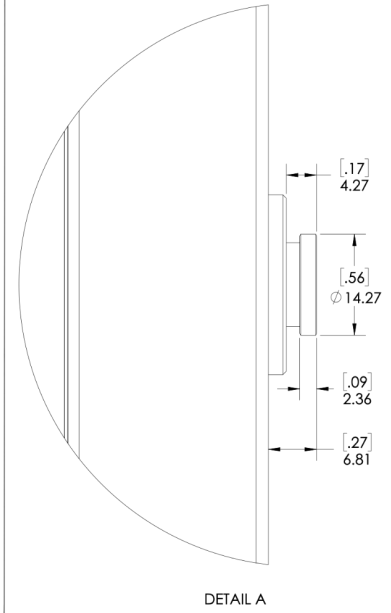

**POWERLOK CONFIGURATION:  
GL7202D**

Power	30A, 120/208V, 3PH, 8.6 kW
Unit Length	72"
Plug Type	NEMA L21-30P
Whip Length	10'
Receptacles	36-C13 & 6-C19
120V Tech Power (5-15R Outlet)	None
Cordlok	None
Monitoring	Display & Ethernet Comm.
Color	Carbon



CUSTOMER APPROVAL*	DATE	UNLESS OTHERWISE SPECIFIED, ALL DIMENSIONS IN MM AND TOLERANCES ARE X: +/- .5 .X: +/- .25 .XX: +/- .13 X°: +/- .5°	TITLE: 7202D MONITORED RACK PDU SPEC	
*CUSTOMER SIGN-OFF IS REQUIRED PRIOR TO MANUFACTURING. *BY SIGNING THIS APPROVAL, THE CUSTOMER AGREES THAT THIS ORDER CAN NOT BE CANCELED AND NO CUSTOM PRODUCTS CAN BE RETURNED.			GREAT LAKES DATA RACKS & CABINETS P.O. BOX 551 EDINBORO, PA 16412 PHONE (814) 734-7303 FAX (814) 734-3907 E-MAIL INFO@GREATCABINETS.COM	
		DWG NO: GL7202D		SHEET 1 OF 1
<p>NOTICE: USE OF THIS DOCUMENT IS SUBJECT TO ACONFIDENTIALITY AND NONDISCLOSURE AGREEMENT WITH GREAT LAKES DATA RACKS &amp; CABINETS AND MAY NOT BE REPRODUCED, DISCLOSED OR UTILIZED IN WHOLE OR IN PART WITHOUT PRIOR WRITTEN AUTHORIZATION FROM GREAT LAKES.</p>				

TOP VIEW

SIDE VIEW

BOTTOM VIEW

ISOMETRIC VIEW